

BILDON 2000 TIMBER FASCIA SYSTEM
 MANUFACTURED AND SUPPLIED BY TOTAL FASCIA LTD.
 OCTOBER 2008

NZ PATENT : 334918
 NZ REG. DESIGN : 30103
 NZ REG. DESIGN : 30102
 © 1999 - W.L. McKENZIE

NZ PATENT : 314624
 NZ REG. DESIGN : 402057
 © 2001 - W.L. McKENZIE

NB:- ALL FASTENINGS ARE STAINLESS STEEL
 GRADE 316. FASCIA BRACKETS AND
 BARGE / GABLE BRACKETS ARE AVAILABLE
 IN BOTH STAINLESS STEEL GRADE 316
 (FOR CORROSIVE ENVIRONMENTS) OR
 GALVANISED FINISH. ALL CORNER PLATES /
 SOAKERS FLAT JOINERS / SOAKERS
 ARE STAINLESS STEEL GRADE 316.

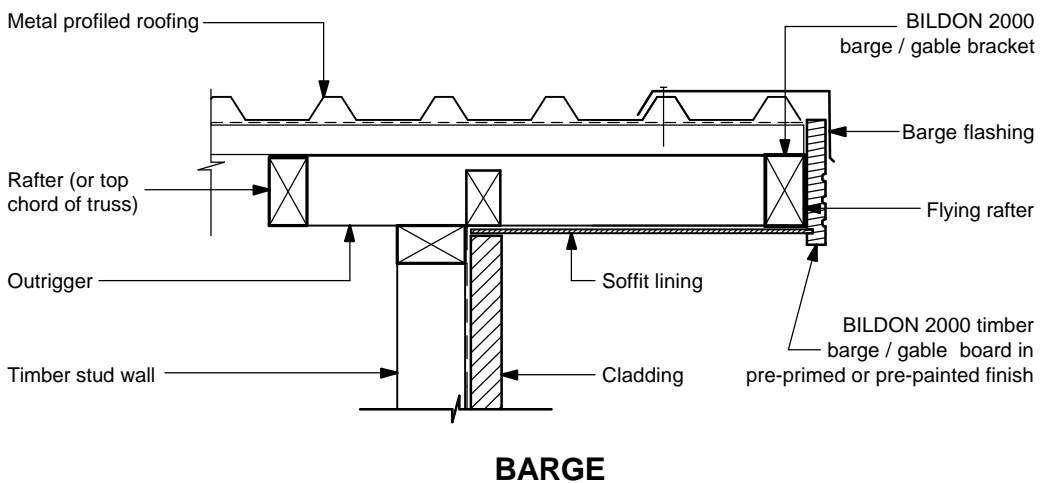
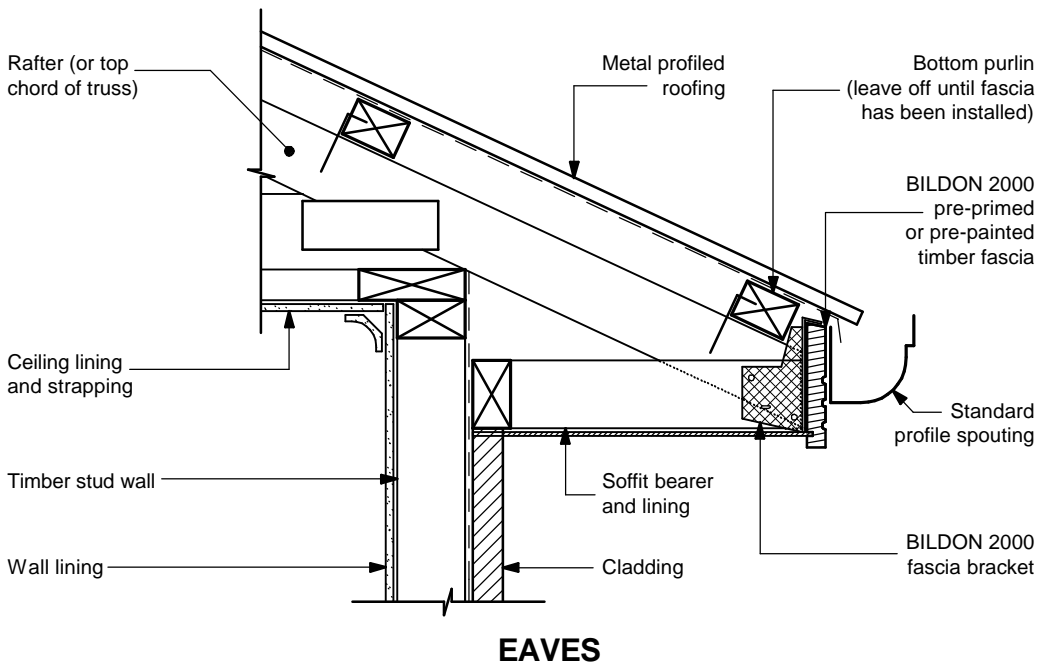

TYPICAL EAVES AND BARGE DETAILS
FOR METAL PROFILE ROOF

(TYPICAL DETAIL: CHECK DIMENSIONS AND MEASUREMENTS BEFORE
 COMMENCING WORK AND INFORMATION ON THIS SHEET SHOULD BE READ
 IN CONJUNCTION WITH OUR INSTALLATION REQUIREMENTS AND BROCHURE)